



## Rockwood in Motion: Urban Renewal Projects Get Underway June 1st

Defining Rockwood's Town Center. Change is on the horizon.

Look for big changes starting this summer, as the Gresham Redevelopment Commission begins transforming the face of Central Rockwood with a distinctive urban design.



New Rockwood MAX station shelter design, 188th & E Burnside

"Rockwood in Motion" projects will benefit residents and businesses alike by providing a fresh new look for the area, improving safety and access to MAX, and jump-starting investment in the Rockwood Triangle. All while reinforcing the message that Rockwood is a special part of Gresham.

### Expect Traffic Delays

Infrastructure improvement projects have already started in some Central Rockwood areas with all projects expected to be underway by June 1.

Here's a list of the Rockwood Urban Renewal Projects that will be going on from now until next summer:

- Burnside widening
- New Rockwood MAX stations
- 188th/187th Avenue Realignment
- SE Stark Boulevard Phase II
- Former Fred Meyer Site interim use

For details about each of these projects see **RENEWAL**, Page 3

### Container redemption center approved for Wood Village



**Halsey Street facility to supplant three East County grocery store collectors**

Oregon's first beverage container redemption center will open this summer in Wood Village.

The Oregon Liquor Control Commission (OLCC) approved an application from the Portland-based Oregon Beverage Recycling Cooperative (OBRC) for the proposed center at 23345 NE. Halsey St.

When it opens this summer, the facility will redeem beverage containers of all types and brands. It marks the first time since 1971 the state has authorized a redemption-only center separate from local grocery stores.

Once opened, beverage containers will no longer be accepted at Fred Meyer in Wood Village; Safeway on Cherry Park Road; and Wal-Mart in Wood Village. Instead, the containers will be taken at the Halsey Street Redemption Center as well as smaller retailers in the area.

The new center will be open from 9AM to 7PM in the summer, and 9AM to 6PM the rest of the year. It will also have a 24-hour drop box for credit account holders.

The OBRC sought the Wood Village location after scrapping an earlier plan to locate Oregon's first centralized redemption facility in Gresham.

See **CONTAINERS**, Page 3

### Mark Your Calendar!

**Wilkes East Neighborhood**

**ANNUAL MEETING**  
**Monday Aug 23, 2010 7PM**

**St Aidan's Church**  
**174th & NE Glisan**

### INSIDE THIS ISSUE

- Rockwood's Renewal Begins
- Container Redemption Center
- East County Courts Approved
- Gresham Police Annual Report
- Reynolds select Henstrand
- Nelson Property Master Plan

### Commissioners Unanimously Approve Plans for East County Courthouse



NE View - Study Model

**After years of delays and missteps, Multnomah County commissioners unanimously approved the design for a new East County Courthouse in Rockwood.**

Since the 1960s, Oregon law has required Multnomah County to provide a facility and court services in Gresham for residents east of 122nd Ave. And there is a court -- but it's little more than one room in the old Gresham City Hall that's overcrowded and run down.

Since that time, countless studies have looked at the need for an eastside courthouse. It was concluded there was such a need, but for one reason or another the project to build a new courthouse got derailed.

That's all going to change with the approval of a new courthouse in Rockwood's town center.

#### Unanimous Approval

The commissioners voted unanimously to approve a three-court building with room for district attorneys, building support and court administration.

Construction is expected to start in January and will be completed by early 2012.

The resolution calls for bonds to pay as much as \$15 million of the estimated \$19.6 million cost.

See **COURTHOUSE**, page 2

**Wilkes East Neighborhood Association Newsletter**

Published quarterly. Over 1500 copies distributed throughout Wilkes East.

The Wilkes East Neighborhood Association (WENA) is a non-profit organization in Gresham, Oregon. Deadline for submission is the 10th of the month prior to publication. Submit material to [info@wilkeaseastna.org](mailto:info@wilkeaseastna.org). WENA reserves all rights, and all copy will be edited for clarity and length. PDF version of this newsletter is available online at: [www.wilkeaseastna.org](http://www.wilkeaseastna.org)

**EXECUTIVE BOARD**

- President** ..... **Kris Freiermuth**  
[krisfreiermuth@wilkeaseastna.org](mailto:krisfreiermuth@wilkeaseastna.org)
- Vice President** ..... **Marc Thornsby**  
[marcthornsby@wilkeaseastna.org](mailto:marcthornsby@wilkeaseastna.org)
- Secretary** ..... **(Vacant)**  
[secretary@wilkeaseastna.org](mailto:secretary@wilkeaseastna.org)
- Treasurer** ..... **Billy Simmons**  
[treasurer@wilkeaseastna.org](mailto:treasurer@wilkeaseastna.org)
- Land Use Chair** ..... **Curt Duval**  
[landuse@wilkeaseastna.org](mailto:landuse@wilkeaseastna.org)
- Members-at-Large** ..... **Lee Dayfield**  
[leedayfield@wilkeaseastna.org](mailto:leedayfield@wilkeaseastna.org)
- ..... **Nancy Pyburn**  
[nancypyburn@wilkeaseastna.org](mailto:nancypyburn@wilkeaseastna.org)
- ..... **Bob Lundbom**  
[webmaster@wilkeaseastna.org](mailto:webmaster@wilkeaseastna.org)

**BOARD MEETINGS**

Board meetings are held on the fourth Monday of each month at 6:30PM. See website for details.

**SPECIAL THANKS**

- Funding for the Wilkes East Neighborhood Newsletter was paid in part by a generous grant from the City of Gresham.
- Printing by Print Results Inc. 503-287-9566
- Meeting hall: St Aidan's Episcopal Church

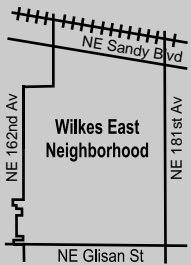

Dear Neighbors • a message from your WENA President

Since the last issue of WENA's Quarterly Newsletter we have seen some positive economic progress.

Teeny Foods has applied for a permit to expand their business at NE 170th Place & Sandy Blvd. The expansion will double their size by adding 43,000 sq ft to accommodate a new product line and needed storage. Presently Teeny Foods is working overtime to fill demand and has recently hired 22 new employees. Their main business is propriety contract manufacturing of custom formula, all natural, whole grain and low fat recipes for restaurants, sports arenas, grocery stores and schools. Owners Rick & Deborah Teeny are native Portlanders and very enthusiastic about their move to Wilkes East. Ground breaking is scheduled for mid-July.

MicroChip of Gresham has recently been taking applications for numerous positions at their SE Stark plant. This is a change from last year and positive one for our community.

WENA will be receiving a grant from the City of Gresham (COG) to assist with publishing this quarterly newsletter. Thank you COG! This grant will also help provide a portable potty for volunteers during each monthly Nakada Nature Park clean-up.

Sanitation equipment is partially donated by United Site Services.

Eastrose Fellowship Unitarian Church had an auction in mid-April to help raise funds for the church and community. Nadaka Nature Park was one of the fortunate recipients. Thank you Eastrose for your generous donation. Welcome on board as a partner to the Friends of Nadaka!

We continue to keep a watchful eye on the Big-Box issue along with several land use items.

Many activities are planned for this summer: WENA's Annual Clean-Up will be Sat July 17th 9AM-Noon at HB Lee. This project is in partnership with Metro; several Neighborhood Watch Groups are planning Garage Sales. Check-out [wilkeaseastna.org](http://wilkeaseastna.org) for dates and locations.

WENA's Annual Meeting is Mon Aug 23rd 7PM at St Aidan's Episcopal Church. Election of officer's will be held and again we are seeking individuals looking to share their time and talents. Come help make a change for your community!

Your neighbor,  
Kristen Freiermuth

**COURTHOUSE (Page 1)**

**Details Remain**

Details remain, such as determining whether the structure will be two or three stories, creating a final design and selling construction bonds later this year. The plans call for a 40,000-square-foot building with three courtrooms (and space for more in the future) to handle misdemeanors, traffic cases and document filing.

**Economic Boon For Area**

Several speakers at the meeting told commissioners they saw the courthouse not just as a place that will be more convenient to eastside residents, but a potential economic boon to one of the poorest areas in the county.

"This is a vital project," said Gresham Mayor Shane Bemis.

Gresham City Councilor Josh Fuhrer added, "I think this project has the potential to be an economic development driver in the area."

**A Rebirth For Rockwood**

This project has been a long time coming," said Commissioner Diane McKeel, a Gresham resident who took over as eastside advocate for the project.

The building is "more than the stones, bricks and glass that we see on paper," said McKeel. "It represents a commitment kept to East County and to Rockwood.", referring to the area where the building will be constructed at Southeast 185th Avenue and Stark Street. "It represents the rebirth of an area left behind for too long. It represents our commitment to providing equal access to due process for the entire county."

The commissioners will vote again in November on whether to approve financing for the project. n

**Graffiti problem returns to Gresham**



**Don't let vandals control your neighborhood!**

Graffiti damages property, and casts a bad light on our community.

Within 24 hours of graffiti appearing:

- **Take a picture of the graffiti**
- **Report graffiti to the police**
- **Clean it off or paint over it**

Remember, graffiti effects everyone. n

**FREE, LOW COST TRANSPORT**



**503.226.0700**

door-to-door rides for seniors and people with disabilities.

**RENEWAL** (from page 1)

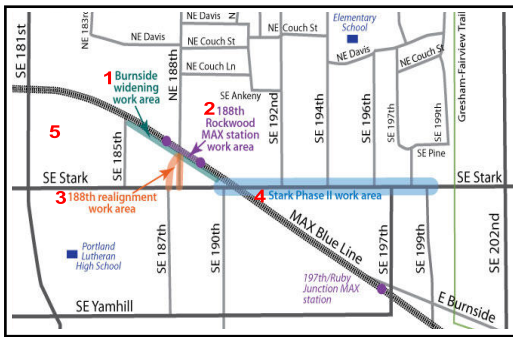

Rockwood in Motion Construction Area Map

**1) Burnside widening**

South side of Burnside between 185th & Stark, new streetlights and wider sidewalks, improved landscaping & trees, on-street parking between 185th & 188th, safer pedestrian crossings at 188th & Burnside, and distinctive pavement and crosswalk treatments. Completion date December 2010.

**2) New Rockwood MAX stations**

TriMet is completely redesigning and rebuilding the 24-year-old Rockwood MAX Station on the Blue Line. This project will collocate the eastbound & westbound platforms on the west side of 188th. It includes two new large open transparent stations adding major upgrades for riders' safety and comfort including increased lighting, new security cameras, new ticket vending machines, and dramatic new public art. Traffic delays are expected in the construction area throughout the project's duration. MAX will continue to operate on schedule. Completion date Spring 2011.

**3) 188th/187th Avenue Realignment**

New street segment aligning NE 188th Ave & SE 187th Ave will create a direct north-south connection through the Rockwood Triangle making a safer path between the MAX station and the neighborhood south of Stark, including a new signalized intersection at SE 187th Ave & SE Stark. The existing segment of SE 188th Ave will be closed and re-purposed. Completion date July 2011.

**4) SE Stark Boulevard Phase II**

This project started in January and is installing new transportation amenities on Stark Street from 190th to 199th Avenues to encourage more walking and biking; improve safety for motorists; and increase the visual appeal of Stark Street with new sidewalks, streetlights and under grounded utilities. Completion date late Summer 2010.

**5) Former Fred Meyer Site interim use**

Until the site is redeveloped, the Gresham Redevelopment Commission will develop a playground and basketball court on the site, adding to the Plaza, walking path, and wildflower garden.

Full story at: [wilkeseastna.org/node/536](http://wilkeseastna.org/node/536) n

**CONTAINERS** (Page 1)

Alisa Shifflett, project manager for the recycling cooperative, praised the Wood Village location — in one of a three-suite building just west of the Best Western — as well suited for dropping off and sorting recyclable beverage containers.

The cooperative started looking for locations outside Gresham after controversy developed regarding the facility's designation as a retail or community service.

The center will have employees to count small amounts of bottles and cans and immediately return deposit money to consumers, and will have new reverse vending machines for consumers to use.

The redemption center concept stems from a change in Oregon's bottle-bill guidelines that required individual supermarkets to collect containers on site.

Full story at: [wilkeseastna.org/node/510](http://wilkeseastna.org/node/510) n

**Gresham Police Department issues 2009 Annual Report**



**Calls for police services increased in 2009. Violent crime is down, theft & vandalism rise, response times improve**

Gresham Police Chief Craig Junginger recently released the first annual report for the Gresham Police Department summarizing crime and accident data, police programs, and personnel highlights from 2009.

Highlights of the report include the activities of the three divisions of the police department, the department's community involvement, and 2009 crime statistics.

To read the 61-page report, follow the link. Full story: [wilkeseastna.org/node/514](http://wilkeseastna.org/node/514) n

**Reynolds selects Henstrand**

**The Reynolds School Board voted unanimously Thursday, May 13, to appoint Joyce Henstrand – currently the interim superintendent – the district's permanent superintendent until June 30, 2011.**

The board has been searching for a permanent superintendent for the past five months, and Henstrand had not applied for the position. However, Theresa Delaney Davis, the board chairwoman, said the board did not believe any of the candidates it had interviewed "was a perfect match," and added the board was impressed with Henstrand's work as interim superintendent.

Full story: [wilkeseastna.org/node/537](http://wilkeseastna.org/node/537) n

**Volunteer.**  
Help restore our urban habitat.

- Sat Jun 19  
9AM • 1PM
- Sat July 24  
9AM • 1PM

**Nadaka Nature Park**  
17500 NE Pacific St

**Advertise Here**

Your message seen by more than **1500 neighbors!**

[Info@wilkeseastna.org](mailto:Info@wilkeseastna.org)

**1874 Victorian Farmhouse**

• TOURS 10-3, THIRD SATURDAY •

A lasting vestige of East Multnomah County's agricultural roots

Zimmerman Park  
17111 NE Sandy Blvd

Fairview-Rockwood-Wilkes Historical Society. [frwhs.org](http://frwhs.org)

**City Council approves Nelson Property Master Plan**



**Public forums, citizen input and design changes complete**

The Gresham City Council approved and adopted the Nelson Property Master Plan at the June 1st meeting.

The Nelson Property is a 2.0-acre parcel located adjacent to and south of the City-owned Nadaka Nature Park, fronting NE Glisan Street at NE 176th.

The second Nelson Property Master Plan Community Forum was held March 31st. At this forum the Preferred Design Alternative (above) was presented which took into account comments from the Parks & Recreation Advisory Subcommittee, Urban Forestry Subcommittee, January 20 Community Forum, Metro Parks & Greenspaces, East Multnomah Soil & Water Conservation District and City staff.

The Master Plan includes approximately 1/3 of the property to be community gardens and orchard. There will also be picnic tables, a nature-based play area, and public restrooms. A walking loop will connect the Nelson property with Nadaka Nature Park. It will be necessary for citizens to obtain additional grant monies to develop the Nelson property. The Nelson Property Summary Report and Community Forum Summary Reports are available on the City's website or by following the link below to this story.

Background: In 2009 the Wilkes East Neighborhood Association and Friends of Nadaka successfully obtained a Metro Nature in Neighborhoods Capital Grant, a grant from the East Multnomah Soil & Water Conservation District and a donation from the Nelson Family Trust to purchase the 2 acre site for use as a neighborhood park. The Trust For Public Lands negotiated the purchase.

Full story at: [wilkeseastna.org/node/533](http://wilkeseastna.org/node/533)

**Dog lovers wanted, off-leash dog park proposed for Gresham**



Many cities the size of Gresham have off-leash dog parks that provide a real convenience and source of enjoyment to dog owners and their pets. These dog parks offer a safe and clean environment by providing an alternative to dog owners who might otherwise let their best friend run loose.

In 2007, the City of Gresham added the only off-leash dog park in the city to Main City Park's master plan, but due to a down economy and budget priorities, development remains delayed for the foreseeable future.

Bonnie Mitchell is a Gresham resident, dog owner, and community organizer. Bonnie is spearheading an effort in cooperation with Gresham Parks & Recreation to locate funding and grants in an attempt to get things moving. In addition to funding, She is also seeking community support and volunteers for this project.

For more information see: [wilkeseastna.org/node/504](http://wilkeseastna.org/node/504)

2010 Area Farmers Markets

<p><b>Fairview Farmers' &amp; Artists' Market</b> Fairview City Hal 1300 Village St Thursdays, 4-8pm May - October</p> <p><b>Gresham Farmers Market</b> ⊞ 3rd and Miller St, Gresham Saturdays, 8:30am-2pm May - October Oregon Trail Food Stamp Market</p> <p><b>Hollywood Farmers' Market</b> ⊞ NE 44th &amp; NE Hancock Saturdays, 8am-1pm May - October Saturdays, 9am-1pm November until Thanksgiving</p> <p><b>Lents International Farmers' Market</b> ⊞ SE 92nd and SE Foster Road Sundays, 9am-2pm June - Mid October Oregon Trail Food Stamp Market</p> <p><b>Montavilla Farmers Market</b> SE 76th and SE Stark St Sundays, 10am-2pm Mid June - October plus November 21st</p>	<p><b>Parkrose Farmers Market</b> ⊞ NE 118th &amp; NE Shaver St Parkrose HS West Parking lot. Saturdays, 9am-3pm May - October Oregon Trail Food Stamp Market</p> <p><b>Portland Farmers Market</b> ⊞ SE 20th &amp; SE Salmon St. Thursdays, 3:30-7:30pm May - September Oregon Trail Food Stamp Market</p> <p><b>Portland Farmers Market</b> ⊞ Portland State University South Park at SW Harrison. Saturdays, 8:30am-2pm Mid March - October Saturdays, 9am-2pm November - December Oregon Trail Food Stamp Market</p> <p><b>Troutdale Farmers' &amp; Artists' Market</b> 551 E Historic Columbia River Highway Downtown Troutdale Saturdays, 10am-2pm April - October</p>
--	--

⊞ Oregon Trail Food Stamp Market

rain or shine!

**Garage Sales** • Find Sales. List Sales. Google Map your route. Absolutely Free! Try [GarageSaleFinder.com](http://GarageSaleFinder.com)

**Is There Crime in Your Neighborhood? Think Again**  
Visit [CrimeReports.com](http://CrimeReports.com)

**Recycling, Hazardous Waste**  
Go to [OregonMetro.gov](http://OregonMetro.gov)

Prevent Crime

Support Your  
Neighborhood  
Watch Group

**Wilkes East  
Neighborhood**

Open to all residents and businesses in the Wilkes East Neighborhood. Be A Part Of Your Community, Plan To Attend.

**ANNUAL MEETING**  
**Monday Aug 24, 2010 7PM**

St Aidan's Church, 174th & NE Glisan

Agenda

- **State of the Neighborhood**
- **City of Gresham Update**
- **Energy Trust of Oregon**  
Donald Shaw, Energy Advisor
- **Mt Hood Medical Center**  
Maegan Vidal  
Community Relations
- **Neighborhood Parks Update**  
Lee Dayfield
- **Election of Board**

Join Your Neighbors. Get involved. Make a difference!